

## What you'll need to get started on your **D.I.Y.** Project

### Materials

Flyscreen mesh (aluminium or fibreglass)  
Flyscreen framing and corner stakes  
PVC spline  
Safety glasses  
Swivel Clips

### Tools

Measuring Tape  
Square and pencil  
Hacksaw  
Screwdriver  
Hammer  
Mitre box  
Spline wheel  
Hot water (to soften PVC spline)  
Sharp knife

### Safety

Read the instructions before beginning your project.  
Wear an approved dust mask when cutting, planing or sanding timber AS/N251716.  
Always keep tools and materials away from children.  
Safety glasses and ear protection should be worn at all times.

## Planning your next **D.I.Y.** Project

The Bunnings **D.I.Y.** brochures are designed to help you step the way through your **D.I.Y.** home projects.

They'll give you the right advice on what materials you'll need, how to get the job done and tips and ideas for achieving the best result.



## Expert **D.I.Y.** advice

If it's advice you're after, come in and discuss the project with one of our experts. Ask about organising Same Day Delivery, Tool Hire, Installation or even enrol in one of our **D.I.Y.** classes.



**BUNNINGS**  
warehouse

For more information go to  
[bunnings.com.au](http://bunnings.com.au)

# D.I.Y.

# Flyscreens

How to make a flyscreen



**BUNNINGS**  
warehouse

BUNN274 05/08

FREE

## How to **D.I.Y.** Make a Flyscreen

Flyscreens are fairly simple to construct. Once you have put one together successfully, you will be able to make enough for the whole house. Build your skills and confidence by completing one window to ensure you are taking the measurements correctly before tackling the rest.

### Please Note:

Information in this brochure is Bunnings' opinion and we don't warrant the accuracy or completeness of that information. Bunnings excludes all liability in relation to the statements in this brochure.

**BUNNINGS**  
warehouse

### Measuring

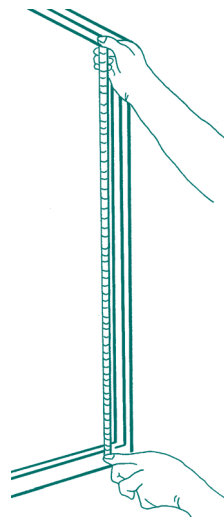

1. Measure the opening width and height as shown in Fig.1.
2. When installing into tracks, measure from the upper inside surface of the top track down to the top outer edge of the bottom track then deduct 3mm for tolerance.
3. Check the vertical measurements on both sides and width measurements top and bottom, as there may be a slight variation in these lengths on older houses.

Fig. 1 Take measurement from upper inside edge of top track

### Cut the frame

1. Cut the frames to length making 45 degree corner cuts using a mitre box and handsaw with a fine toothed blade. In some situations, corner stakes may require a reduction in the length and width of frames to allow for their inclusion so check this detail.

### Make the frame

Make the frame:

1. Insert the corner stakes and join the frame together. See figs. 2a and b. If a little force is required to get it together, use a block of wood between the frame and the hammer to prevent damage.

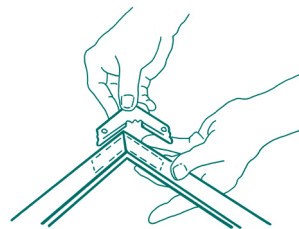

Fig. 2a Stake fits in corner of frame

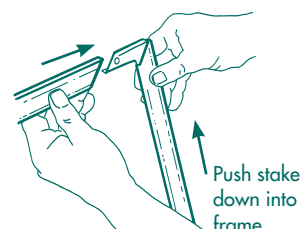

Fig. 2b Push frame onto stake

2. Test the frame in the opening. If the opening or flyscreen is out of square, use a little pressure to adjust the flyscreen frame to fit the opening shape.

### Fixing the flyscreen mesh

1. Lay the frame on a flat surface and drape the mesh over it.
2. Cut the mesh on 3 sides to the outside edge of the frame but on the 4th side allow a generous 75-80mm overlap to enable the fabric to be stretched tight.
3. Warm the PVC spline in hot water to make it more pliable so it is easier to manipulate. Use your fingers to work it into position.
4. Start about 90mm from the corner and at the opposite end to the one that has the extra allowances for stretching.
5. Use the spline roller to press the PVC spline into the slot.
6. After completing one end, stretch the mesh tight whilst at the same time inserting the spline into the remaining 3 sides. See fig.3.
7. Trim the excess with a sharp knife.
8. Attach the catch or swivel clips. Then fit the completed screen into place.

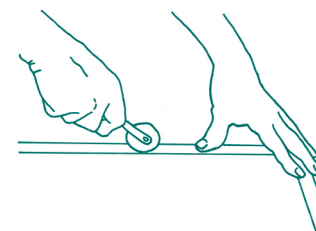
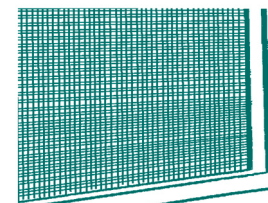

Fig. 3 Press spline into groove with spline wheel

### Finishing

The completed screen is now ready to be put into place.



### **D.I.Y.** Hints and Tips

1. Painting should be done before flyscreen is attached to frame.

For further expert advice consult the qualified Team Members at your local Bunnings Warehouse.